

Cat.5e Jack

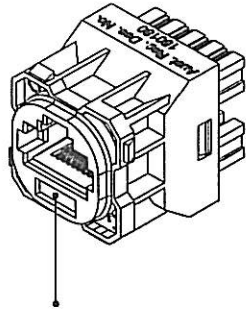

Marking : AMDEX

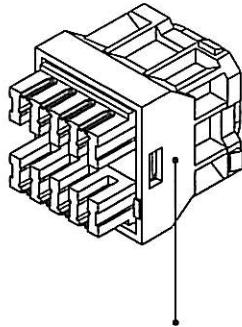

Printed Letter :

Cat.5e

N3674



CJ1

Dimensions : m/m

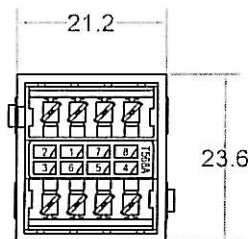
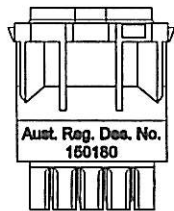

Wire Map:

RJ-45 8P8C	IDC Block:
1	1
2	2
3	3
4	4
5	5
6	6
7	7
8	8

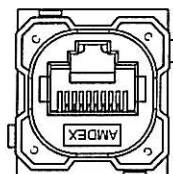
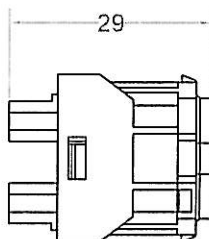

Performance :

Meets Cat.5e EIA/TIA 568B.1 Standard.

Materials:

Plastic Body	: Fireproof ABS UL-94V0
RJ-45 Jack	: 8P8C 50 micro inches gold plated
PCB	: FR-4 / 1.0mm UL-94V0
IDC Body	: Fireproof ABS UL-94V0
IDC Pin	: Bronze & Tinned

Label Color Code : T568 A

IDC Description : For 22-26 AWG.
For 110 or Krone punch-down Tool

Electrical Specifications :

Insulation Resistance:	500M ohms (min.)
Contact Resistance :	20m ohms (max.)
Current Rating :	1.5 Amps .
DC Resistance :	0.1 ohm (max.)
Withstanding Voltage:	1000 VAC RMS @ 60Hz / 1 min.

Mechanical Specifications:

IDC Punch Down Cycle :	Over 250 Cycles (min.)
RJ-45 Jack Insertion Cycle:	Over 2000 Cycles (min.)
Operation Temperature :	-40 ~ +70 degree / C

Description:

Cat.5e unshielded, Clipsal keystone jack, with AMDEX logo

DRAW NO:		ITEM NO:	DA103
	APPR	G.O.	CUSTOMER:
UNIT: m/m	CHECK		DATE:
SCALE: 1:1	DESIGN	TOLERANCE:	± 1 · X ± 0.2 · XX ± 0.15